

APPLICATION FOR
 Residential, Building, Electrical, Plumbing, Mechanical, and Demolition Permit
FROM - The City of Napoleon, Ohio, Building Department
 255 West Riverview Avenue; P.O. Box 151; Napoleon, Ohio 43545 - Telephone (419) 592-4010

ENTRY NO. _____

PERMIT NO. 3476 ISSUED 3-13-95

JOB LOCATION 1040 Chesterfield

LOT 14 Twin Oaks 1st
 (Subdivision or Legal Description)

ISSUED BY BND
 (Building Official)

OWNER Bruce Pickering PHONE 599-0993

ADDRESS 140 Orchard Nap.

AGENT Mock/Bucher PHONE 592-0825

ADDRESS 1227 Dodd Nap.

USE: Residential Commercial Industrial
 Other _____

WORK: New Addition Replacement Remodel

ESTIMATED COST = \$ 170,000.00

	Base	Plus	Total
<input checked="" type="checkbox"/> Building	\$ <u>9.00</u>	\$ <u>288.80</u>	\$ <u>297.80</u>
<input checked="" type="checkbox"/> Electrical	\$ <u>15.00</u>	\$ <u>120.00</u>	\$ <u>135.00</u>
<input checked="" type="checkbox"/> Plumbing	\$ <u>9.00</u>	\$ <u>54.00</u>	\$ <u>63.00</u>
<input checked="" type="checkbox"/> Mechanical	\$ <u>18.00</u>	\$ <u>22.00</u>	\$ <u>40.00</u>
<input type="checkbox"/> Demolition	\$ _____	\$ _____	\$ _____
<input type="checkbox"/> Zoning	\$ _____	\$ _____	\$ _____
<input type="checkbox"/> Sign	\$ _____	\$ _____	\$ _____
<input checked="" type="checkbox"/> Water Tap	\$ <u>650.00</u>	\$ _____	\$ <u>650.00</u>
<input checked="" type="checkbox"/> Sewer Tap	\$ <u>272.00</u>	\$ _____	\$ <u>272.00</u>
<input checked="" type="checkbox"/> Temp Water	\$ <u>5.00</u>	\$ _____	\$ <u>5.00</u>
<input checked="" type="checkbox"/> Temp Elec.	\$ <u>10.00</u>	\$ _____	\$ <u>10.00</u>

Additional Structure _____ Hours _____
 Plan Review: Electric _____ Hours _____

TOTAL FEES \$ 1472.80
 Less Fees Paid \$ _____
 BALANCE DUE \$ 1472.80

ZONING INFORMATION

District	Lot Dimensions	Area	Front Yard	Side Yard	Rear Yard
<u>S</u>	<u>150.15 X 150</u>	<u>22,522</u>	<u>40'</u>	<u>15'</u>	<u>20'</u>

Max Height	No. Pkg. Spaces	No. Ldg. Spaces	Max Cover	Petition or Appeal Required-Date
<u>40'</u>	<u>2 per</u>		<u>30%</u>	

WORK INFORMATION

Building: Ground Floor Area 2759 sq. ft. Basement Floor Area _____ sq. ft.
 Garage Floor Area 849 sq. ft. 2nd Floor Area 339 sq. ft. Other Porch 73 sq. ft.
 Size: Length 84.75' Width 70.67' Stories 2 Height 22
 Building Volume (for Demolition Permit) _____ cubic feet

Description of Work: New Home

720° x 87.

ELECTRICAL: Contractor Speiser Electric Phone _____

Address _____ ESTIMATED COST = \$ _____

Type of Work: New Service Change Rewiring Add'l Wiring TEMPORARY ELEC. REQUIRED - Yes No

Size of Service 200 Underground Overhead _____ Number of New Circuits 40

Description of Work: _____

PLUMBING: Contractor _____ Phone _____

Address _____ ESTIMATED COST = \$ _____

WATER TAP REQUIRED - Yes No Size _____ Type of Pipe _____ Water Dist. Pipe _____

SANITARY SEWER TAP REQUIRED - Yes No Size _____ Type of Pipe _____ Dr. Waste Vt. Pipe _____

STREET SEWER TAP REQUIRED - Yes No Type of Pipe _____ STREET TO BE OPENED - Yes No

Main Building Drain Size = _____ Main Vent Pipe Size = _____

LIST NUMBER OF PLUMBING FIXTURES BELOW:

Water Closets = 4 Bathtubs = 2 Showers = 1 Lavatories = 5 Kitchen Sinks = 1 Disposal = 1

Clothes Washer = 1 Floor Drains = 2 Dishwasher = 1 Other _____ Total = 18

Description of Work: _____

MECHANICAL: Contractor _____ Phone _____

Address _____ ESTIMATED COST = \$ _____

HEATING SYSTEM - Forced Air Gravity Hot Water Steam Unit Heaters Radiant Baseboard

TYPE OF FUEL - Electric Natural Gas Propane Wood Coal Solar Geothermal Other _____

NUMBER OF HEAT ZONES = 1 HOT WATER - One (1) Pipe Two (2) Pipes Series Loop

ELECTRIC HEAT - Number of Circuits _____ Number of Furnaces 1 Number of Hot Air Runs 20

Number of Hot Water Radiators _____ Total Heat Loss 68,000 Rated Capacity of Furnace/Boiler 80,000

LOCATION OF HEATING UNITS - Crawl Space Floor Level Attic Suspended Roof Outside
18" above garage floor

Description of Work: _____

DRAWINGS REQUIRED: All applications must be accompanied by two (2) complete sets of Drawings including Site Plans, Foundation Plans, Floor Plans, Structural Framing Plans, Exterior Elevations, Section and Details, Stair Details, Electrical Layout, Plumbing Isometric, Heating Layout, etc. All Plans shall be drawn to scale, show all existing structure on the Site Plans, and show electric panel and furnace locations.

READ AND SIGN BELOW: The undersigned hereby makes application for a Permit for all work described herein and agrees to complete the work in strict accordance with all applicable provisions of the current edition of the C.A.B.O. Building Code, the Napoleon Building and Zoning Codes, the Napoleon Engineering Department Rules and Regulations, Standard Specifications and other pertinent sections of the Napoleon Code of Ordinances.

Signature of Applicant _____ Date _____

1380 1.7

WATER TAPPING PERMIT

issued by

The Napoleon Water Distribution Department
255 West Riverview Ave. Napoleon, Ohio 43345 Pn. 592-4010

Permit No. W-0560

Issued

3-27-95

Received of

Mock/Buchanan Bldgs

(\$ 650)

Area for tapping permit to supply water service to Lot No.

14

Sub Div.

Twin Oaks 1st

Material

10 40 Chestnut

Tap Size

1

Cost \$

650

.00 Plumber

Date completed

Approved by

Jeffrey C. Montague
water distribution dept.

finance director

Name

Size of tap

1"

Date

5-17-95

Street and No.

1040 Chestnut

Old Tap No.

New Tap No.

9539

Size and Kind of Main

8" C-900

Location of Main

4' North of North curb

Depth of Main

5'

Distance from Hydrant/Valve

210' West of Hyd 403

Distance to Curb Stop from Corp.

51'

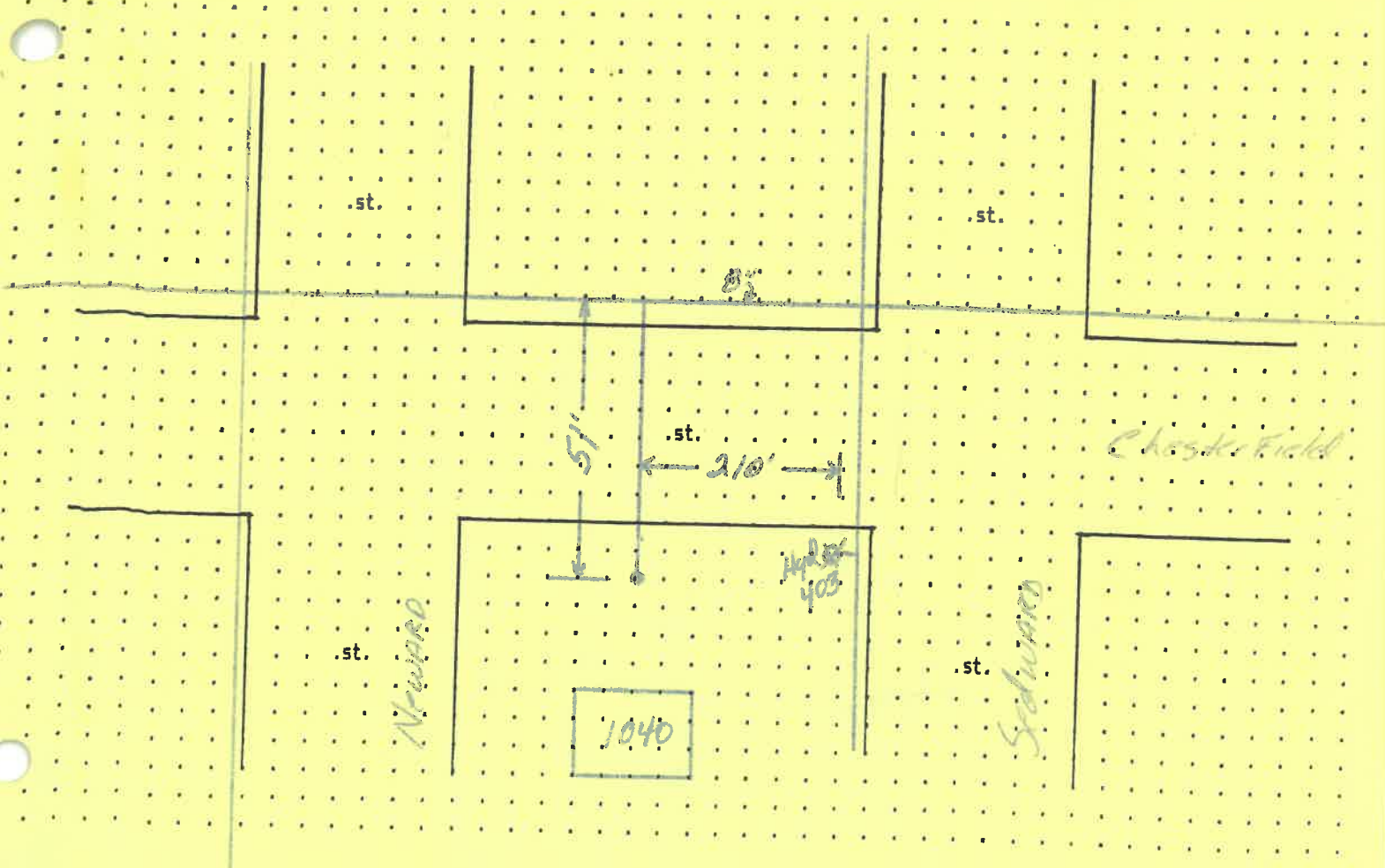

Mock-Buehrer Blds.

1040 Chesterfield

LOT 5

150.15'

Installed 4-4-95

LOT 14
22,522 SQ. FT.

150.00'

39.33'

70.67'

PROPOSED HOME
4020 SQ. FT.

32.74'

84.75'

32.74'

150.00'

depth C.O. 32"

4.25'

4" P.V.C SANITARY

4" P.V.C Storm

40'

150.15'

CL

CHESTERFIELD DRIVE

60' R/W

